

COMPUTER LAB CLASSROOMS

A Planning Guide

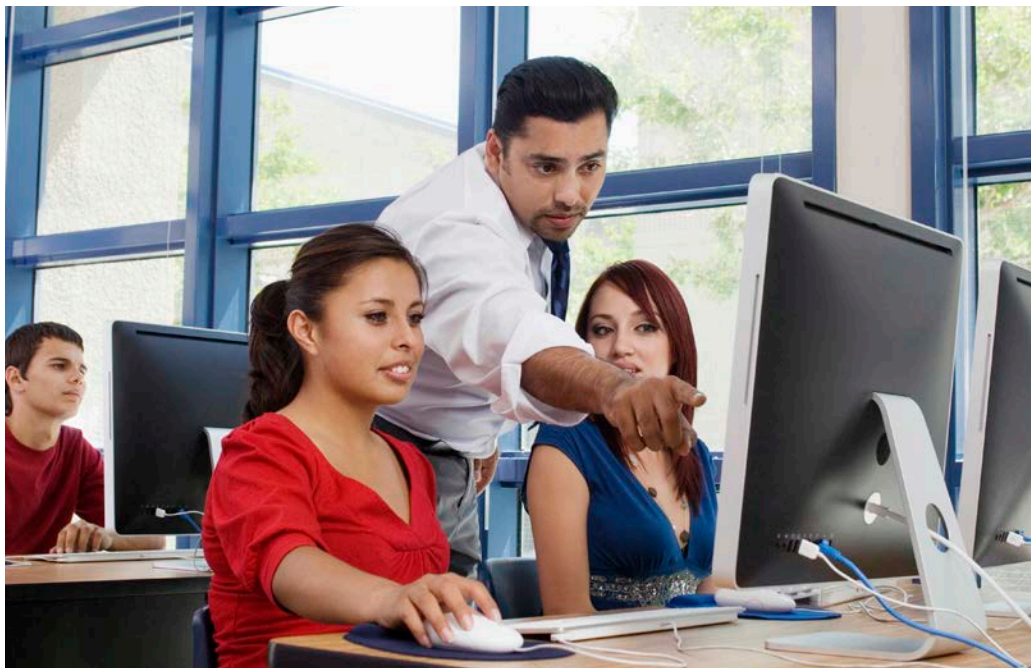

EVOLVING TECHNOLOGY EVOLVING CLASSROOMS

Technology has impacted every facet of daily life and educators are responsible for teaching the next generation how to harness the power of computers across a myriad of fields, such as graphic design, accounting, computer animation, engineering, architecture, math, and programming. Students are no longer simply learning basic word processing. They are now using professional-grade and industry-standard software programs, designing apps, and preparing for a dynamic and computer-rich post-graduation experience. As a result, computer labs themselves have evolved to meet both the specific demands of technological hardware and classroom layouts required by the teachers.

Different academic disciplines require different lab layouts — some are more traditional with workstations in lecture rows, others need partitions to ensure testing privacy; others have students working in small groups, while still others need flexible work areas for project planning.

The layouts are as varied as the subjects taught, as are the specific needs of districts, teachers, and the actual physical space. With over twenty years experience in the education market, Interior Concepts stands ready to work with you every step of the way — from designing your perfect technology classroom, maximizing your physical space, delivering quality Michigan-made furniture built to your exact specifications, and installing furniture solutions ready for outfitting with technology.

The following pages introduce you to some of the many possible technology layouts which will hopefully initiate a conversation or kick-start thinking about what might work for your programs, teachers, and students. We will create layouts for as many different computer lab classrooms as you have, and show you how our furniture allows for growth, reconfiguring, and the evolution of technology itself so your investment will last for years.

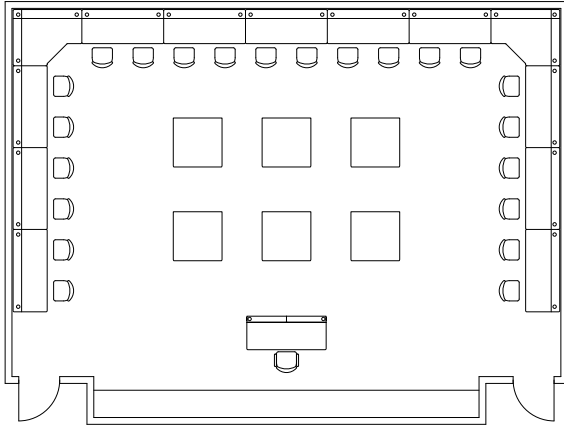

PERIMETER CLASSROOMS

With workstations arranged along the walls, perimeter labs allow teachers to easily maneuver around the classroom and manage student work. Teachers can easily keep an eye on what a large number of students are working on, and students can quickly turn around when the teacher needs to make a presentation.

Perimeter labs function well for subjects that have students working fairly autonomously without a lot of lecture-based learning. The large center area also facilitates creation of a central collaborative work area from either moveable tables or stationary stations — making perimeter layouts conducive to subjects requiring both individual and small-group projects, such as a CAD or graphic design classes.

Features of Perimeter-Style Classrooms:

- Layouts shown below are for 22 students
- Chase Wire Management System (*see page 7 for details*)
- Varied panel heights; they can match worksurface height, rise above worksurface to define workspaces, or be even higher to create a shelf as pictured at right.
- Popular worksurface heights: 25", 27", or 29"

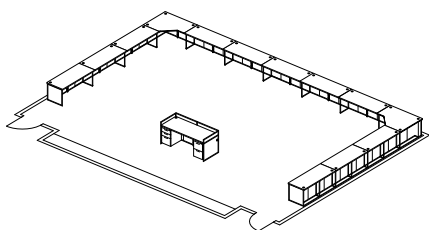

Perimeter without Backsplash

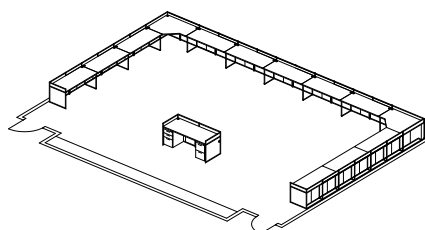

Perimeter with Backsplash

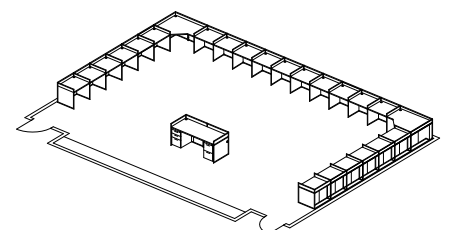

Perimeter with Backsplash and Intermediate Panels

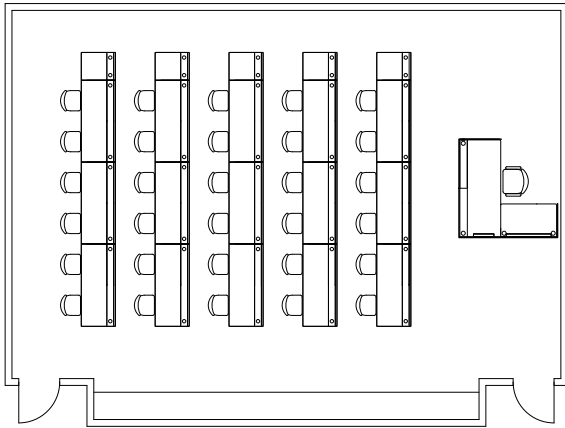

LECTURE CLASSROOMS

Classrooms with students arranged in rows is the classic layout, and that is because many subjects are best taught with instructors leading the class. Lecture layouts allow students a clear view of the teacher without having to turn around, teachers can easily see when a student has a question, and the front of the classroom can be used to work or project lessons onto a screen.

Lecture labs function well for subjects that have students spending substantial portions of each class listening to or working along with a teacher and then working autonomously on classwork such as math or word/data processing. These front-facing layouts also function well for testing environments when front, side, and intermediate panel heights are raised to reduce student visibility (shown top right).

Features of Lecture-Style Classrooms:

- Layouts shown below are for 30 students
- Chase Wire Management System (*see page 7 for details*)
- Varied panel heights; they can match worksurface height, rise above worksurface to define workspaces, or be even higher to create a secure testing space.
- Popular worksurface heights: 25", 27", or 29"

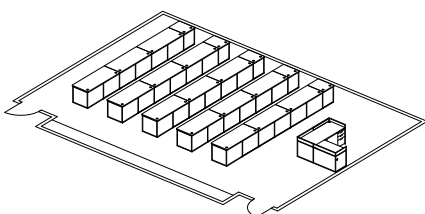

Perimeter without Backsplash

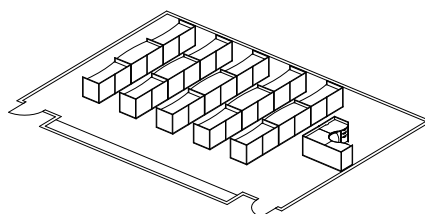

Perimeter with Backsplash

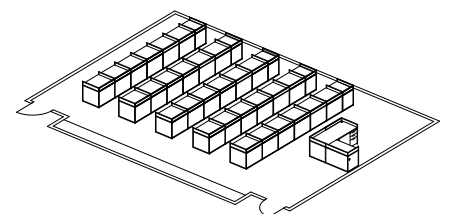

Perimeter with Backsplash and Intermediate Panels

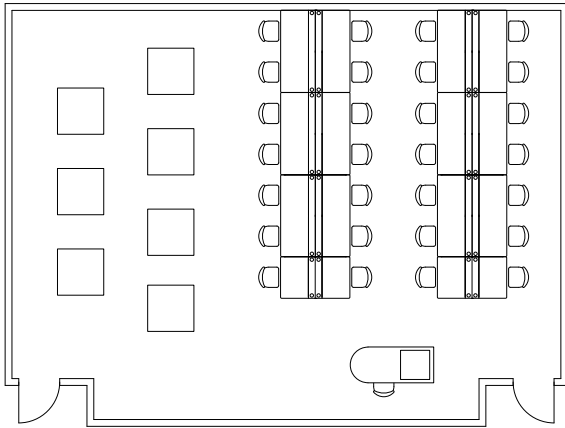

BACK-TO-BACK CLASSROOMS

Back-to-back layouts are similar to lecture layouts, but allow many students to fit in a relatively small footprint. Often, these classrooms have split uses — one area for non-computer-based work, and another for working with technology. Teachers might not do much lecturing because some students may be facing away from them, but the students do have the ability to easily interact with fellow classmates.

Back-to-back labs fit courses where students work primarily on their own, at least for part of the curriculum, such as computer animation, drafting, fashion design (note the sewing carts tucked under the worksurface in the middle image), or a research lab.

Features of Lecture-Style Classrooms:

- Layouts below are for 30 students; layout above is for 28 students
- Chase Wire Management System (*see page 7 for details*)
- Varied panel heights; they can match worksurface height, rise above worksurface to define workspaces, or be even higher to create a secure testing space.
- Popular worksurface heights: 25", 27", or 29"

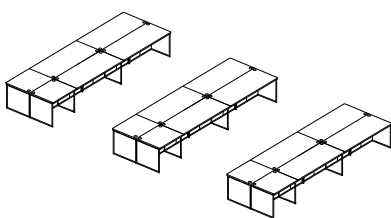

Perimeter without Backslash

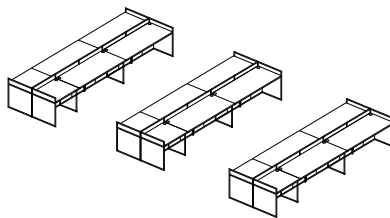

Perimeter with Backslash

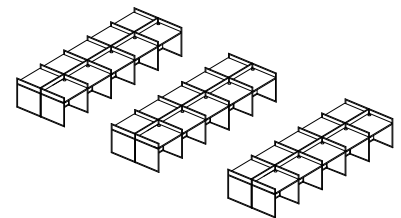

Perimeter with Backslash and Intermediate Panels

FLEXIBLE DESIGNS

Every instructor has a teaching style or idea for how they want to teach, and Interior Concepts has stepped up to the plate with layouts and workstation designs that can be personalized for your space and learning environment. With our ability to design our workstations by the inch, we can also build our stations to fit your unique room layout, accommodating doors, window ledges, and columns. Bring us your ideas and we will actively work with you to bring your vision to life.

If you are looking for classroom and computer tables, Interior Concepts has numerous options to fit your needs, including tables outfitted with power.



CHASE WIRE MANAGEMENT

Our Chase Wire Management system provides an interconnecting passageway that links workstation to workstation. The system features sliding doors for easy access to wires and cables. When workstations are against a wall, the back panel of the workstation will not be included so you can easily access existing building power.

If stations are in the middle of the room, the stations should be equipped with our eight-wire electrical system which is mounted in the upper portion of the Chase system. Once connected to the building's electrical system by a qualified electrician, the system will bring power to the freestanding run of workstations.

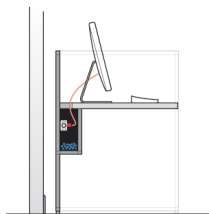

Suspended Chase

- Sliding access doors
- 5" D x 11" H
- Bottom deck prevents cables from dropping to floor

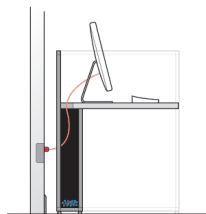

Full Height Chase

- Sliding access doors
- 5" D; height equals distance from floor to underside of worksurface

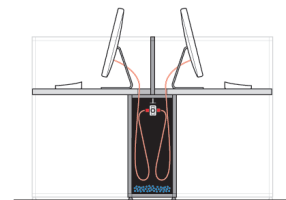

Back-to-Back Chase

- Sliding access doors
- 10" D; height equals distance from floor to underside of worksurface



Tailored Design

Interior Concepts builds workstations to the inch, meaning we build precisely to your physical space. Have a column, low bank of windows, or lots of doors? No problem, we can go around it, lower the panels to a backsplash, or run stations right up to the door.



Interior Concepts™
solutions that fit.

18525 Trimble Court, Spring Lake, MI 49456

800.678.5550 | interiorconcepts.com